

The depth of penetration of **cancellous bone** is controlled by the surgeon who stops advancing the drill when the Soft Tissue Reference Line of the screw shank is flush with the skin surface. There will be instances when the cortex of cancellous bone is sufficiently hard that the Power Drill Torque Limiter will activate and decouple the drilling and therefore stop further unnecessary advancement of the screw.

The depth of penetration of the cortex of **diaphyseal bone** is controlled by the Power Drill Torque Limiter, that decouples the drill when the required torque has been reached.



Soft Tissue Reference Line

## Power Drill Torque Limiter

The UNYCO Cancellous Screw must be inserted with the Power Drill Torque Limiter. **Drill the screw as close to perpendicular to the bone surface using a low speed power drill** with the Power Drill Torque Limiter mounted.

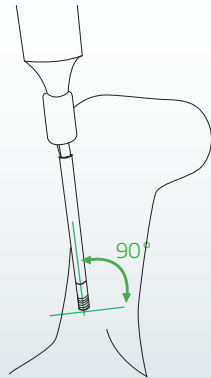

The system is stable only when 4 UNYCO Cancellous Screw are applied in a biplanar fashion within the Large Multiscrew Clamp per bone segment.

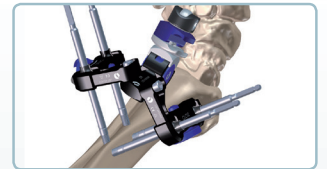

Specifically in the foot, minimum 3 UNYCO Cancellous Screws must be clustered with the specific Radiolucent Foot Unit.

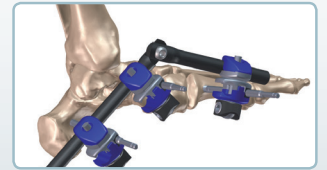

## How Uni-cortical Screws can be stable

Galaxy UNYCO single screw

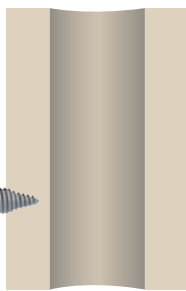

Bi-cortical single screw

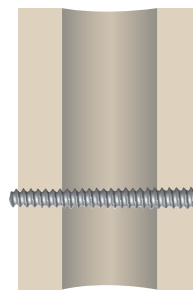

Galaxy UNYCO 3 or 4 screws

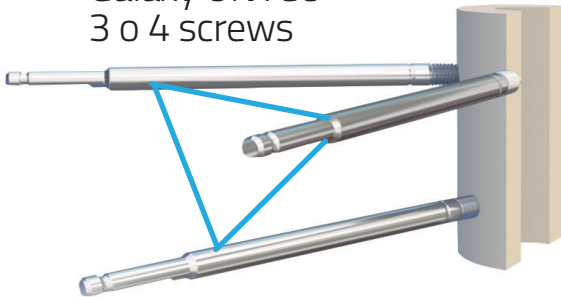

Bi-cortical 2 screws

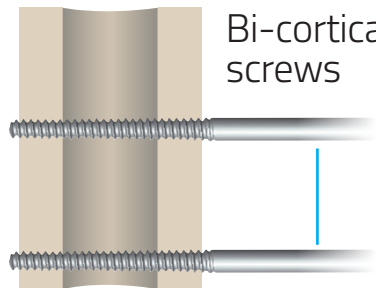

Torque



Flexion load



Axial load (pull-out resistance)

# Frames and Equipment

Galaxy UNYCO is compatible with the Galaxy Fixation system. Galaxy Fixation clamps and rods are all available single sterile packed.

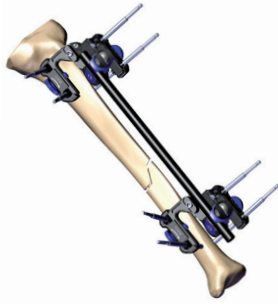

99-93794  
Galaxy UNYCO  
Diaphyseal Tibia Box



99-93793  
Galaxy UNYCO  
Ankle Bridging Box - Delta Frame



99-93792  
Galaxy UNYCO  
Ankle Bridging Box - Unilateral Frame

See Brochure and Operative Technique for detailed ordering information.

## Tips and Tricks

If the power drill used for surgery does not have a Quick Connection system, it is important to **ensure the Power Drill Torque Limiter is coaxially inserted within the chuck holder.**

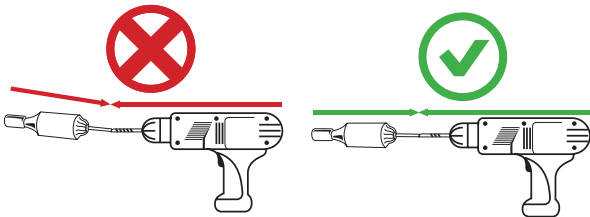

**Avoid toggling or bending the screw once inserted.**

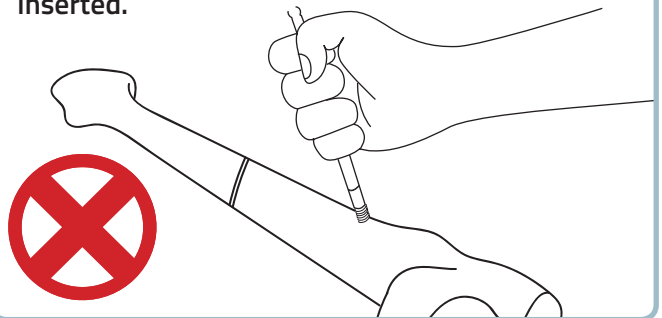

**The clamp should not be pulled/pushed after the second screw is inserted.**

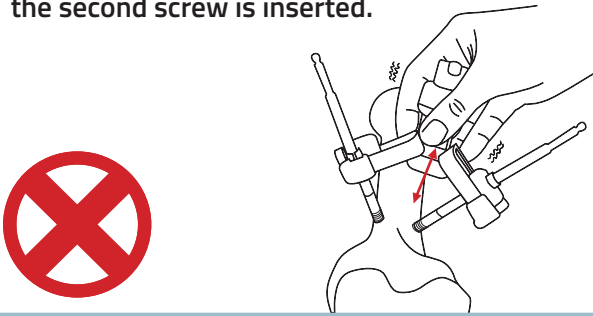

**Check the tightening of the metal rings prior to and after the reduction.**

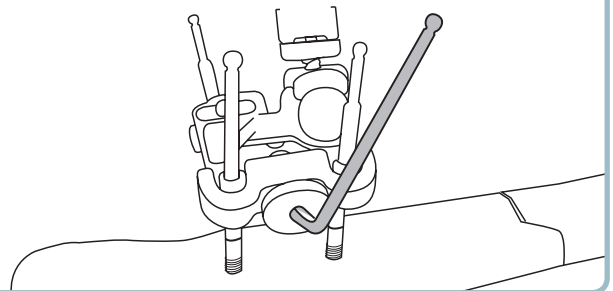

Distributed by:

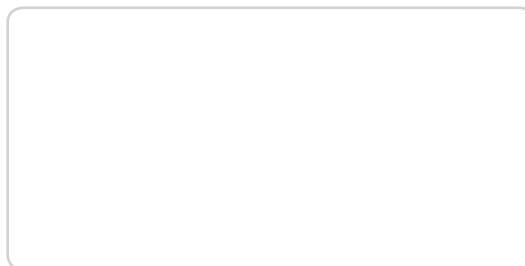

Manufactured by:  
ORTHOFIX Srl  
Via Delle Nazioni 9, 37012 Bussolengo (Verona), Italy  
Telephone +39 045 6719000, Fax +39 045 6719380

CE 0123

 @galaxyunyco  
[www.galaxyunyco.com](http://www.galaxyunyco.com)

[www.orthofix.com](http://www.orthofix.com)

MC-1514-PL A 10/15

Instructions for Use: See actual package insert for Instructions for Use.

Caution: Federal law (USA) restricts this device to sale by or on the order of a physician. Proper surgical procedure is the responsibility of the medical professional. Operative techniques are furnished as an informative guideline. Each surgeon must evaluate the appropriateness of a technique based on his or her personal medical credentials and experience. Please refer to the "Instructions for Use" supplied with the product for specific information on indications for use, contraindications, warnings, precautions, adverse reactions and sterilization.

  
**ORTHOFIX®**